

Model OSBH Series

Shear Beam Load Cell

The OSBH series single ended shear beam load cell is designed for high accuracy platform scales and a variety of process weighing applications.



- Alloy tool steel construction for high accuracy.
- Electroless nickel plated for corrosion resistance.
- Fully sealed to IP66.

SPECIFICATIONS

MODEL	OSBHA, OSBHB, OSBHC
Rated capacity (R.C.)	0.5, 1, 2, 3, 5, 10t 1, 2, 4, 5, 10, 20Klbs
Rated output (R.O.)	3mV/V ± 0.25%
Non-linearity	≤ 0.03% R.O.
Hysteresis	≤ 0.02% R.O.
Non-repeatability	≤ 0.02% R.O.
Creep error	≤ 0.03% in 20min.
Zero balance	1% R.O.
Compensated temperature range	-10 ~ 40 °C
Operating temperature range	-20 ~ 70 °C
Safe temperature range	-30 ~ 80 °C
Temp. effect on rated output	±0.02% LOAD/10 °C
Temp. effect on zero balance	±0.03% R.O./10 °C
Terminal input resistance	380 ~ 400 Ohms
output resistance	345~355 Ohms
Insulation resistance (Min.)	≥ 2000 MOhms at 50V DC
Recommended excitation	10V
Maximum excitation	15V
Electrical connection	Ø5mmx4Cx6m
Safe overload	150% R.C
Ultimate overload	300% R.C

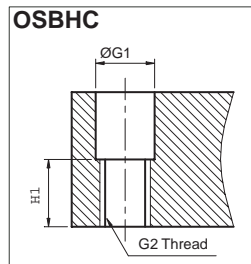
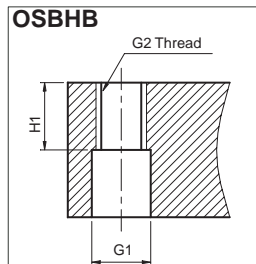
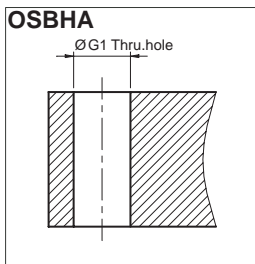
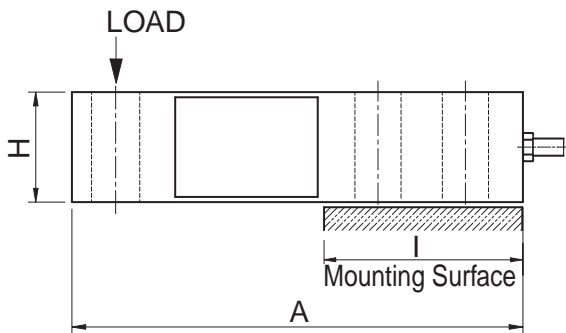
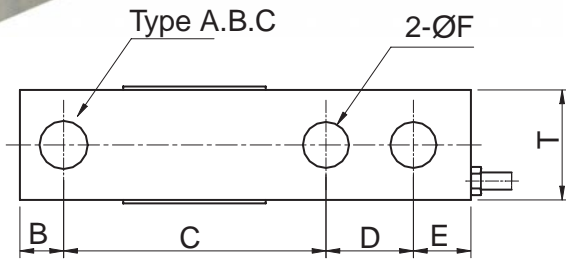

ORDERING INFORMATION

OSBHA - 5T

MODEL	CAPACITY
OSBHA	0.5T, 1T, 2T, 3T, 5T, 10T.
OSBHB	1Klb, 2Klb, 4Klb, 5Klb, 10Klb, 20Klb.
OSBHC	

WIRING INFORMATION

RED : EXC. (+) WHITE : EXC. (-)
GREEN : SIG. (+) BLUE : SIG. (-)
BARE : GND

Dimension-mm(inch)

Capacity	A	B	C	D	E	F	G	ØG1	G2	H	H1	I	Weight: :Kg(lbs)
0.5~2t	131	12.7	76.2	25.4	16.7	31.8	13.5	13.5	M12x1.75P	32	16	57	0.8
	(5.15)	(0.50)	(3.00)	(1.00)	(0.65)	(1.25)	(0.53)	(0.53)		(1.25)	(0.62)	(2.24)	(1.7)
3~5t	171	19	95	38	19	38	20	20	M20x2.5P	38	19	76.2	1.8
	(6.71)	(0.74)	(3.74)	(1.49)	(0.74)	(1.49)	(0.78)	(0.78)		(1.49)	(0.74)	(2.99)	(4.0)
10t	225.6	25.4	124.0	50.8	25.4	50.8	26	26	M24x2P	50.8	25	110	4.1
	(8.88)	(1.00)	(4.88)	(2.00)	(1.00)	(2.00)	(1.02)	(1.02)		(2.00)	(0.98)	(4.33)	(9.0)
1~4klb	131	12.7	76.2	25.4	16.7	31.8	13.5	13.5	1/2" -20 UNF	32	16	57	0.8
	(5.15)	(0.50)	(3.00)	(1.00)	(0.65)	(1.25)	(0.53)	(0.53)		(1.25)	(0.62)	(2.24)	(1.7)
5~10t	171	19	95	38	19	38	20	20	3/4" -16 UNF	38	19	76.2	18.0
	(6.71)	(0.74)	(3.74)	(1.49)	(0.74)	(1.49)	(0.78)	(0.78)		(1.49)	(0.74)	(2.99)	(4.0)
20klb	225.6	25.4	124.0	50.8	25.4	50.8	26	26	1" -14 UNF	50.8	25	110	4.1
	(8.88)	(1.00)	(4.88)	(2.00)	(1.00)	(2.00)	(1.02)	(1.02)		(2.00)	(0.98)	(4.33)	(9.0)

* Specifications are subject to change without notice

MAY.2000