

## Model OBBH Series

Bending Beam Load Cell (10Kgf ~ 500Kgf)



The OBBH series single ended bending beam load cell is designed for tension or compression loading applications including bench scale and conveyor weighing.

- 17-4PH stainless steel construction for high accuracy and corrosion resistance.
- Fully welded seal with stainless steel bellows for hostile environments and washdown applications.

### SPECIFICATIONS

MODEL	OBBH
Rated capacity (R.C.)	10, 20, 50, 100, 200, 500kgf
Rated output(R.O.)	2mV/V $\pm$ 0.3%
Non-linearity	$\leq$ 0.03% R.O.
Hysteresis	$\leq$ 0.02% R.O.
Non-repeatability	$\leq$ 0.02% R.O.
Creep error	$\leq$ 0.03% in 20min.
Zero balance	$\leq$ 1% R.O.
Compensated temperature range	-10 ~ 70°C
Operating temperature range	-20 ~ 80°C
Temp. effect on rated output	$\leq$ 0.02% LOAD/10°C
Temp. effect on zero balance	$\leq$ 0.02% R.O./10°C
Terminal input resistance	400 Ohms $\pm$ 20 Ohms
Terminal output resistance	350 Ohms $\pm$ 5 Ohms
Insulation resistance (Min.)	2000 MOhms at 50V DC
Excitation Voltage	10V(Recommended) /15V(Maximun)
Electrial connection	$\varnothing$ 5mmx3m(22AWG x 4Core Shielded)
Protection class	meets IP 67
Safe overload	150% R.C
Ultimate overload	300% R.C

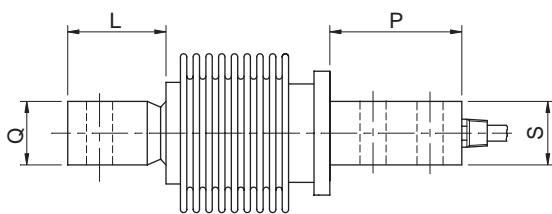
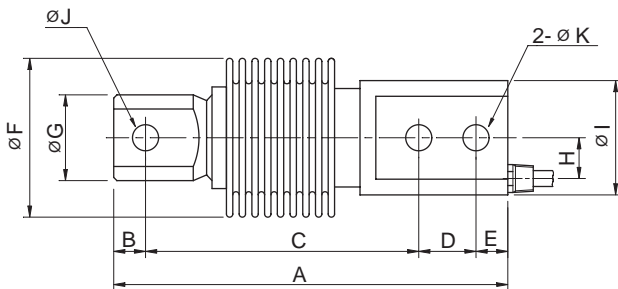

### ORDERING INFORMATION

#### OBBH - 50

MODEL CAPACITY  
10, 20, 50, 100Kgf,  
200, 500Kgf

### WIRING INFORMATION

RED : EXC. (+) WHITE : EXC. (-)  
GREEN : SIG. (+) BLUE : SIG. (-)  
BARE : GND

### Dimension-mm

Rated Capacity	A	B	C	D	E	F	G	H	I	J	K	L	P	Q	S	Weight (kg)
10~100kgf(98.1N~980.7N)	120	10	82	18	10	38	20	10	32	8.5	8.5	21	41	15	20	0.9
200~500kgf(1.96KN~4.90KN)	210	22	133	40	15	50	29	14	52	12	14	44	75	25	40	1.9

\* Specifications are subject to change without notice

MAY.2000