

Model CDBH Series

Double Ended
Shear Beam Load Cell (5tf~ 25tf)

The CDBH series double ended shear beam load cell is designed for high accuracy hopper, tank scales and a variety of process weighing applications.

- Alloy tool steel construction for high accuracy
- Electroless nickel plated for corrosion resistance
- Fully sealed to IP67

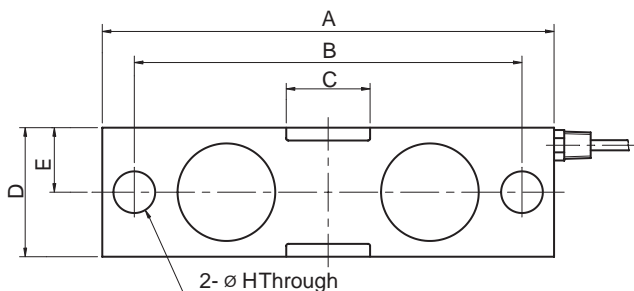
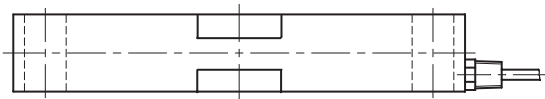

SPECIFICATIONS

MODEL	CDBH	
Rated capacity (R.C.)	5, 10, 15, 25tf 10, 20, 30,50Klbf	
Rated output(R.O.)	3mV/V ± 0.25%	
Non-linearity	≤ 0.03% R.O.	
Hysteresis	≤ 0.03% R.O.	
Non-repeatability	≤ 0.03% R.O.	
Creep error	≤ 0.03% in 20min.	
Zero balance	≤ 1% R.O.	
Compensated temperature range	-10 ~ 70 °C	
Operating temperature range	-20 ~ 80 °C	
Temp. effect on rated output	≤ 0.02% LOAD/10 °C	
Temp. effect on zero balance	≤ 0.03% R.O./10 °C	
Terminal input resistance	700 Ohms ±10 Ohms	
Terminal output resistance	700 Ohms ±7 Ohms	
Insulation resistance (Min.)	2000 MOhms at 50V DC	
Excitation Voltage	10V(Recommended) /15V(Maximun)	
Electrical connection	5 ~15tf	ø5mmx6m(22AWG x 4Core Shielded)
	25tf	ø9mmx10m(22AWG x 4Core Shielded)
Protection class	meets IP 67	
Safe overload	150% R.C	
Ultimate overload	300% R.C	

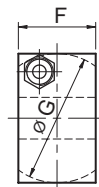

ORDERING INFORMATION

CDBH - 5T

MODEL CAPACITY
5, 10, 15, 25tf
10, 20, 30, 50Klbf

WIRING INFORMATION

RED : EXC. (+) WHITE : EXC. (-)
GREEN : SIG. (+) BLUE : SIG. (-)
BARE : GND

Dimension-mm(inch)

Rated Capacity	A	B	C	D	E	F	G	H
5,10tf (49.03, 98.07KN)	222	190.5	41.2	49.3	24.65	36.6	50.6	20.5
	(8.74)	(7.5)	(1.62)	(1.94)	(0.97)	(1.44)	(1.99)	(0.80)
15tf (147.1KN)	222	190.5	41.2	63.5	31.75	38	63.5	20.5
	(8.74)	(7.5)	(1.62)	(1.94)	(1.25)	(1.50)	(2.5)	(0.80)
25tf (245.2KN)	343	292.1	82.6	74.6	37.3	62	76	33
	(13.5)	(11.5)	(3.25)	(2.94)	(1.47)	(2.44)	(2.99)	(1.30)
10,20 Klbf (44.48, 88.97KN)	222	190.5	41.2	49.3	24.65	36.6	50.6	20.5
	(8.74)	(7.5)	(1.62)	(1.94)	(0.97)	(1.44)	(1.99)	(0.80)
30 Klbf (133.45KN)	222	190.5	41.2	63.5	31.75	38	63.5	20.5
	(8.74)	(7.5)	(1.62)	(1.94)	(1.25)	(1.50)	(2.5)	(0.80)
50 Klbf (222.41KN)	343	292.1	82.6	74.6	37.3	62	76	33
	(13.5)	(11.5)	(3.25)	(2.94)	(1.47)	(2.44)	(2.99)	(1.30)

* Specifications are subject to change without notice

MAY.2000