

Skylift - II series

Crane Scale (1t ~ 5t)

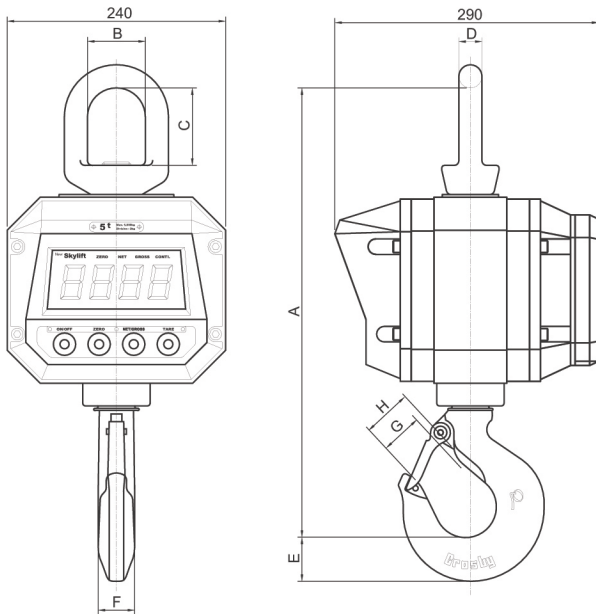

I.R. Remocon



Features;

- Robust design & High accuracy
- Durable cast aluminium housing
- Large brightness LED display(38mm)
- Sturdy swivel hook("Crosby" or equivalent)
- 24bit Sigma-delta A/D converter
- Easy access rechargeable battery
- Watertight push button switch
- I.R. remote control (on/off, zero, net/gross, tare, hold)
- Optional wireless display & controller

SPECIFICATIONS

Model	NCS	
Rated capacity	1, 2, 3, 5t	
Display	1 t	30mm height LED, 5 digit
	2, 3, 5 t	38mm height LED, 4 digit
Accuracy	1/2000, 1/2500, 1/3000	
Power	6 volt lead-acid rechargeable battery	
Battery operating time	80 hours between recharging	
Recharging time	Approx. 4 hours	
Operating temp.	-10 °C~ 50 °C	
Enclosure	Cast aluminium, IP64	
Safe overload	200% of rated capacity	
Ultimate overload	500% of rated capacity	
Hook	Swivel hook with thrust bearing	
Switches	On/Off, Zero, Net/Gross, Tare	
Annunciators(LED lamp)	Continuation(Auto power OFF), Zero, Net, Gross	
Accessories	(1) Battery, 6 volt rchargeable (2) Battery charger (Free voltage, AC85~260V) (3) I.R. Type Remocon	
Option	1) Wireless Handy Indicator(Model : BS-52R) 2.4GHz Bluetooth Communication 2) Wireless Desktop Indicator / Large Display	

ORDERING INFORMATION

NCS - 5T

MODEL CAPACITY
1, 2, 3, 5ton



BS-52R
(Option)

Dimension-mm

Model	R.C	Resolution	A	B	C	D	E	F	G (with latch)	H (without latch)	Weight(kg)
NCS - 1T	1 t	0.5 kg	398	50	63	19	29	24	29.5	30.2	18 kg
NCS - 2T	2 t	1 kg	448	63	85	25.4	37	33	35.8	38.1	20 kg
NCS - 3T	3 t	1 kg	448	63	85	25.4	37	33	35.8	38.1	20 kg
NCS - 5T	5 t	2 kg	480	63	85	25.4	46	42	42.9	45.2	23 kg